

40 FT CONTAINERPOOL

event infinity pool



The container pool is built to the dimensions of a 40-foot container (2,19 x 2,44 m), with a height of 1,2 m and a water depth of 1 m. It weighs approximately 5.5 tons when empty and around 32,5 tons when filled.

Inspired by shipbuilding, the pool features a robust steel frame covered with steel plates, maintaining the industrial aesthetic of a container.

Its exterior showcases a sleek container-style design, enhanced by five glazed panels—three at the front, one at the back, and a fully glazed front—offering an open and modern look. It is an infinity pool.

The overflow channel is finished with a wooden frame, which gives it an elegant design finish.

At the rear, all essential pool tech, including the filtration system, heater, and circulation pump, is conveniently housed and easily accessible.

For nighttime ambiance, underwater lighting creates a striking visual effect.

Installation requires a water connection and a 16-amp electrical supply. A railing and steps are included for added convenience and safety.



40 FT CONTAINERPOOL

previous events



40 FT CONTAINERPOOL

axonometry and views

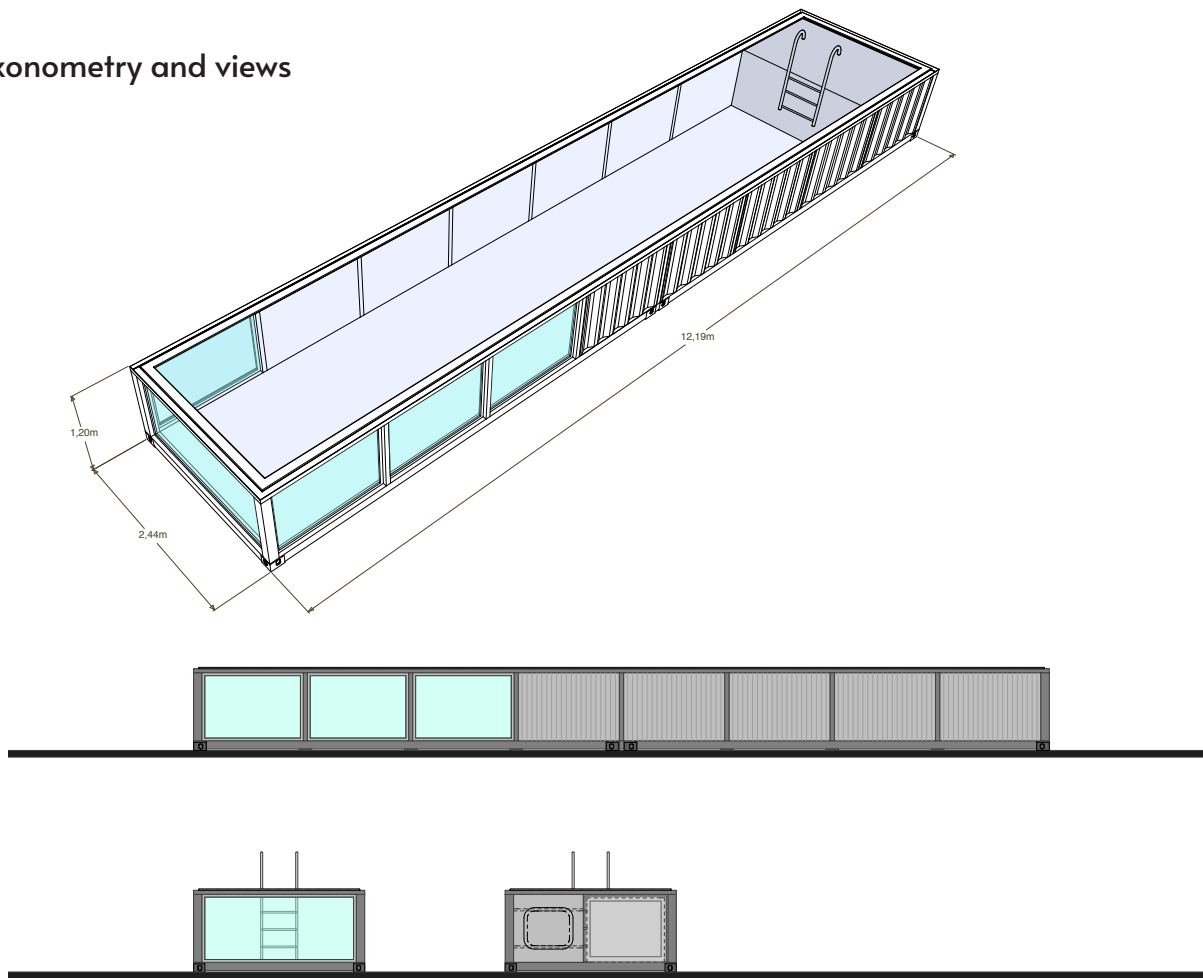

crane lifting possibilities

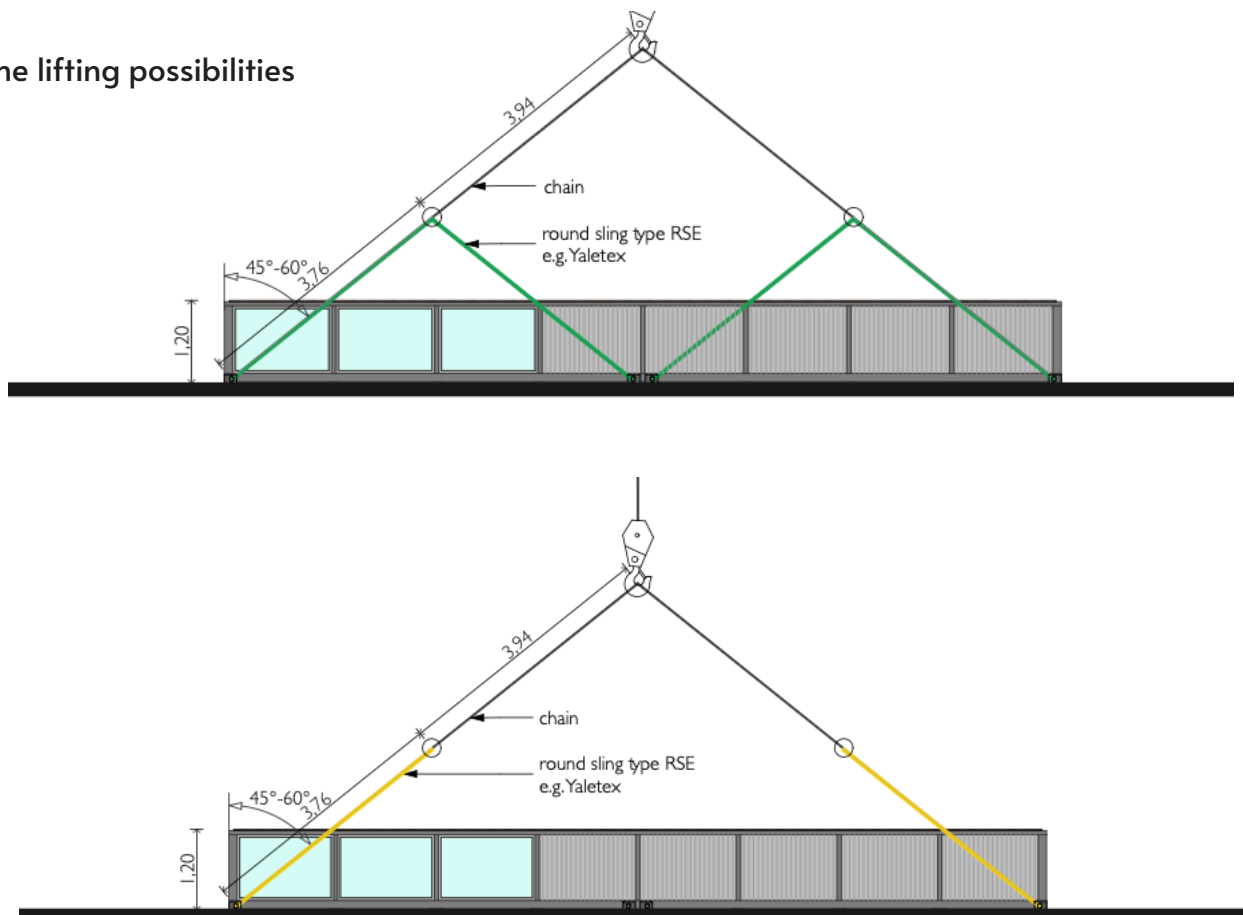

40 FT CONTAINERPOOL

POOL EQUIPMENT SPECIFICATIONS

Filter Tank – 500 mm, made of fiberglass-reinforced polyester, with a side outlet (1 ½ inch), including a pressure gauge, air vent, and drain. Filter material: glass granulate.

Wilo Swimming Pool Filter Pump – 15 m³/h, 380V, 0.69 kW.

PVC Ball Valve – 63 mm.

Floor Inlet Nozzle – Made of red brass, 1 ½ inch, with a V4A stainless steel cover, flow-adjustable.

Underwater Spotlight – 300W/12V, with a V4A stainless steel cover.

Safety Transformer – 600 VA/12V.

Floor Drain – Made of red brass, with a V4A stainless steel cover.

Swimming Pool Instant water heater – 16 kW, including a control thermostat, safety temperature limiter, and flow switch.

Electrical Connection – Two-row electrical distribution box on a PVC mounting plate, equipped with all necessary built-in devices, such as an RCD circuit breaker, fuses, and contactors for pool heating.

Power Supply – Via a 32A CEE industrial plug. Electrical connection for underwater spotlights.

Artdepartment-Berlin GmbH

artdepartment

phone +49 172 380 30 55

mail@artdepartment-berlin.com

www.artdepartment-berlin.com

www.2x20ft.com

